

# Tullinge Garden City

## Urban Extension



LOCATION: Botkyrka, Stockholm, Sweden  
 CLIENT: HSB Bostad  
 TYPE: Masterplanning, Detail Planning, Architecture  
 STATUS: Built  
 DATE: 2003  
 REF: Richard Langerfors, HSB, +46-8-785 39 15

In contrast to the existing suburban plan in Tullinge HSB, a local building co-operative decided to build a more compact, but still green, garden suburb area. The design followed the principles of classic garden city planning as seen in developments around Sweden from the first half of the 20th century. The garden city works on the principle of a variety of house sizes and functions within a classic network of streets, main roads and squares. All houses have access to a private garden and the houses all face the street creating an intimate urban environment.

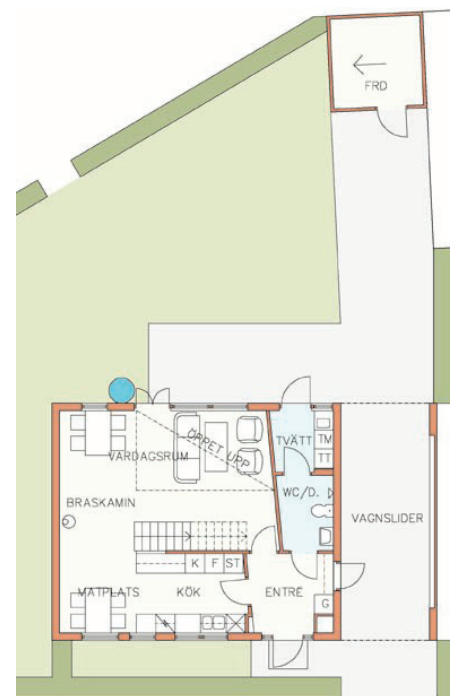

VILLA  
GROUND  
FLOOR:



FIRST  
FLOOR:

